



Introduction

This user guide will cover select features of the mobile site. These include:

Uploading Photos and Notes	2
GPS-Tagged Photos.....	2
GPS-Tagged Notes	3
Form Submissions.....	3
Mobile Site Applications	4
Trap Counts	4
Animal Days per Acre.....	5

Mobile Site

Uploading Photos and Notes

Photographs and field notes can be uploaded to myObservatory while in the field. Uploaded photographs and field notes are tagged with your GPS coordinates for viewing by location from the map.

GPS-Tagged Photos

On the Take GPS-Tagged Photo screen, you will be given the option to take a new photograph or to select an existing photograph to upload to myObservatory. You may tap the Choose file or Retake button to change your selection at any time.

The screenshot shows the 'Take GPS-Tagged Photo' screen. At the top, there's a 'Photo Preview' area with a camera icon. Below it is a 'Save In...' dropdown menu with a 'Choose...' button. A checkbox is checked with the text 'Show only stations of type "Photo" or "Photos" in list above?'. Below that is a 'Send to E-Mail (Optional)' field. A 'Choose file' button is present, with 'No file chosen' text next to it. At the bottom, there are 'Latitude' and 'Longitude' input fields, and a 'Save' button.

Once you have taken or selected your photo, a preview of your photo will appear where it says Photo Preview.

You may enter a photo name and description or leave these fields blank.

You may select an existing dataset and station to upload your photograph to (by tapping the blue drop down selection menu where it says "Choose..." and selecting an existing dataset and station from the drop down list) or you may create a new dataset and station to upload your photograph to (by tapping the same drop down selection menu and selecting "New...").

You may also elect to email the photo by entering one or more email addresses in the Send to E-Mail field (email addresses should be separated by a comma).

Your current location coordinates will display in the Latitude and Longitude fields.

Tap Save when you are ready to upload your photograph.

Uploaded GPS-tagged photos can then be viewed from the View Data in List and the View Data in Map screens as well as on the desktop site.

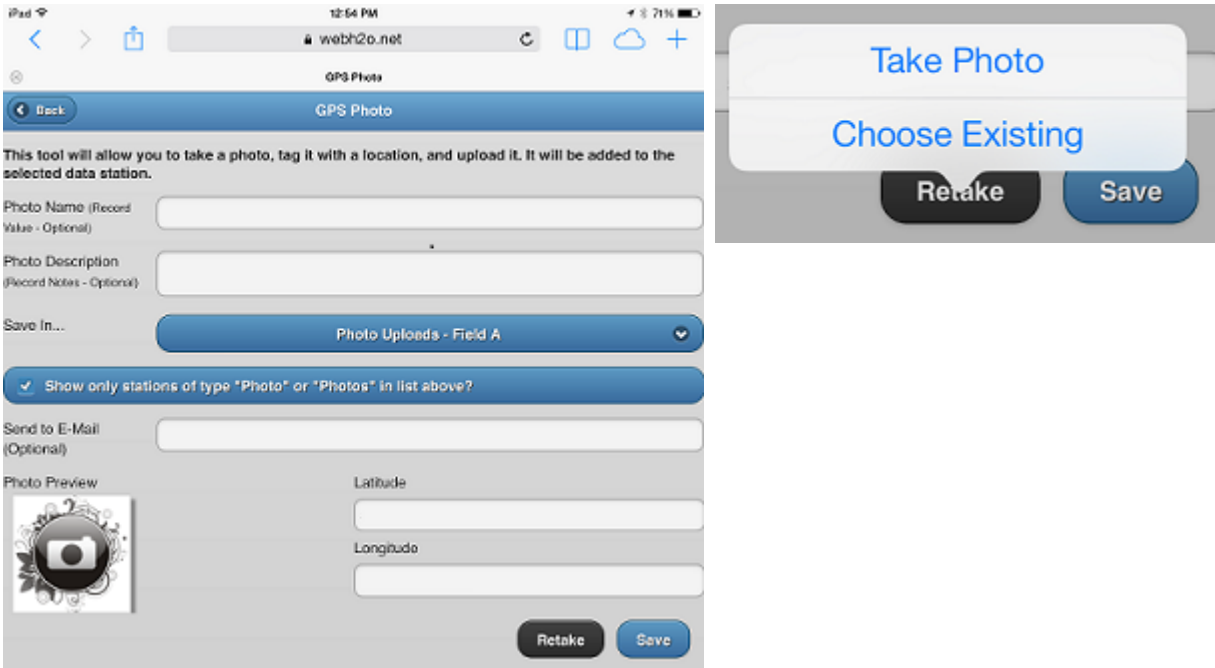

GPS-Tagged Notes

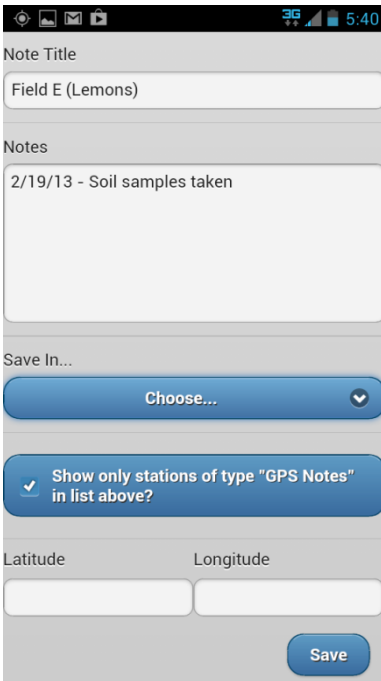

On the Enter GPS-Tagged Notes screen, enter a title for your notes in the Note Title field and your notes in the Notes field. Both of these fields are required.

You may select an existing dataset and station to upload your notes to (by tapping the blue drop down selection menu where it says “Choose...” and selecting an existing dataset and station from the drop down list) or you may create a new dataset and station to upload your notes to (by tapping the same drop down selection menu and selecting “New...”).

Your current location coordinates will display in the Latitude and Longitude fields.

Tap Save when you are ready to upload your notes.

Uploaded GPS-tagged notes can then be viewed from the View Data in List and the View Data in Map screens as well as on the desktop site.

Form Submissions

Forms that were created on the desktop site can be accessed on the mobile site and form entries can be submitted while in the field.

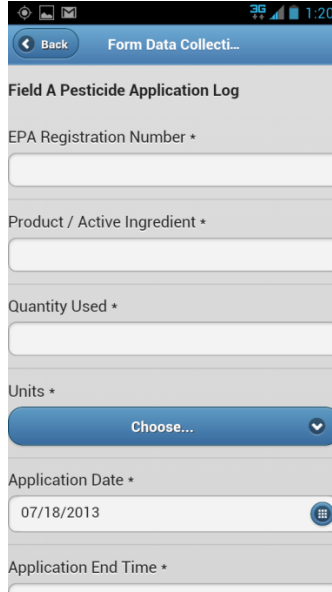
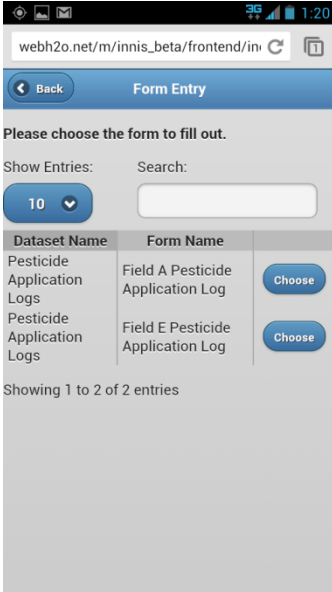

On the Form Entry screen, select the form you wish to submit an entry for.

On the Form Data Collection screen, enter the information and data requested (remembering that required fields are denoted with an asterisk) and tap Save when you are ready to submit your form entry.

Form submissions can be viewed from the desktop site.

Mobile Site Applications

Two mobile site applications are Trap Counts and Animal Days per Acre.

Trap Counts

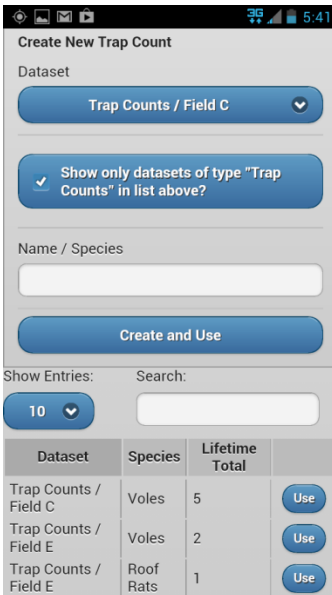

On the Trap Counts screen you may make a new trap count entry or you may add a new species to the list.

When adding a new species, select an existing dataset and station to add the species to (for example, Trap Counts / Field C shown here) or create a new dataset and station (by tapping the dataset drop down selection menu and selecting "New...").

Once you have selected or created the appropriate dataset and station, enter the name of the species and then tap Create and Use.

When making a new trap count entry, tap Use next to the appropriate dataset and species.

Trap Count entries can be viewed from the View Data in List and the View Data in Map screens as well as on the desktop site.

Animal Days per Acre

The Animal Days per Acre feature allows you to view ADA reports for various grazing areas as well as define grazing areas using the feature’s mapping tools (acreage is calculated automatically). You may then enter the number of animals grazing in an area during a specified period of time and the animal days per acre is calculated automatically.

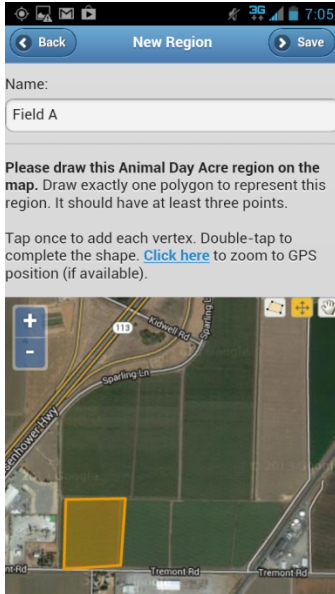

To create a new ADA region, tap the New Region button on the Choose Region screen (not pictured here). The New Region screen will be displayed. Here you may name the region and use the map’s shape tools to draw the region on the map.

To draw the region on the map, tap the shape tool to select it (the first button in the top right-hand corner on the map) and then tap the map at one of the region’s vertices. Tap once on the map at each vertex of the region. Double tap on the map at the location of the last vertex to complete the region.

To modify the region before saving, tap the modify tool to select it (the second button in the top right-hand corner on the map) and then tap the region to select it. The region will then be highlighted and locations along the perimeter of the region that you can move will be indicated with circles. Tap any of these circles and, without lifting your finger, move the circles around on the map. Lift up when you are satisfied with the modifications to the region.

Tap Save when you are ready to save your region.

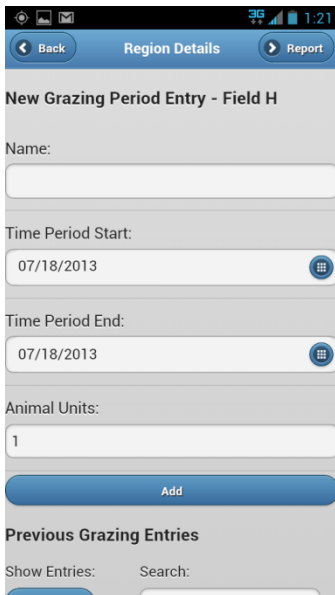

To add a new grazing period entry to an existing region, tap Use next to the desired region on the Choose Region screen (not pictured here).

On the Region Details screen, enter a name for the New Grazing Period Entry, the time period start and end dates, and the number of animal units for this time period and region. Tap Add when done. The lifetime ADA will be updated for this region upon submission.

Previous grazing period entries are displayed below.

You may also access the ADA Report for this region by tapping the Report button on this screen. The ADA Report displays the lifetime ADA as well as this month, last month, this quarter, last quarter, this year, last year, and custom date range ADAs.

Add

Previous Grazing Entries

Show Entries: Search:

10 ▼

Name	Start	End	Animal Units	ADA	
June	2013-06-06	2013-06-15	25	6.097560975609756	Delete
July	2013-07-11	2013-07-25	30	10.975609756097562	Delete

Showing 1 to 2 of 2 entries

Time Period ADA

This Month <i>2013-07-01 to 2013-07-31</i>	10.975609756097562
Last Month <i>2013-06-01 to 2013-06-30</i>	6.097560975609756
This Quarter <i>2013-07-01 to 2013-09-30</i>	10.975609756097562
Last Quarter <i>2013-04-01 to 2013-06-30</i>	6.097560975609756
This Year <i>2013-01-01 to 2013-12-31</i>	17.073170731707318
Last Year <i>2012-01-01 to 2012-12-31</i>	0

Custom:

07/18/2013 0.7317073170731707

to

07/18/2013